

Date: May 14, 2024 Author: Centerline: 778-201-5790 DWG#: 001
REV#: 001

Comments:

MAREX
Brad Loewen: 604-855-4214



City of Chilliwack
Address: Yale Rd between Nowell St and Young Rd
Scope of Work: Various construction works
Closure Description: Single lane alternating - Fig 7.8 & 11.2/4
This plan is based on a 50 km/h roadway speed
All specifications are based on the MoTI manual 2020 edition
Date and Times: Per approved times by City

Notes:

Minimum 3.5m travel lane width will be retained.

TCS on site may make changes as required in the field and will note any changes in their risk assessment.

AFADs are not suitable due to insufficient road space.

TCPs will require radios for communication.

Work zone may be shortened from shown.

Nowell St and Yale Road intersection will need to be put into flash for TCPs to control it.

Transit will be prioritized.

Contractor must ensure that the use and placement of all traffic control persons (TCPs) conform to WorkSafe BC's OHS Regulation Part 18 and the TMM 2020.

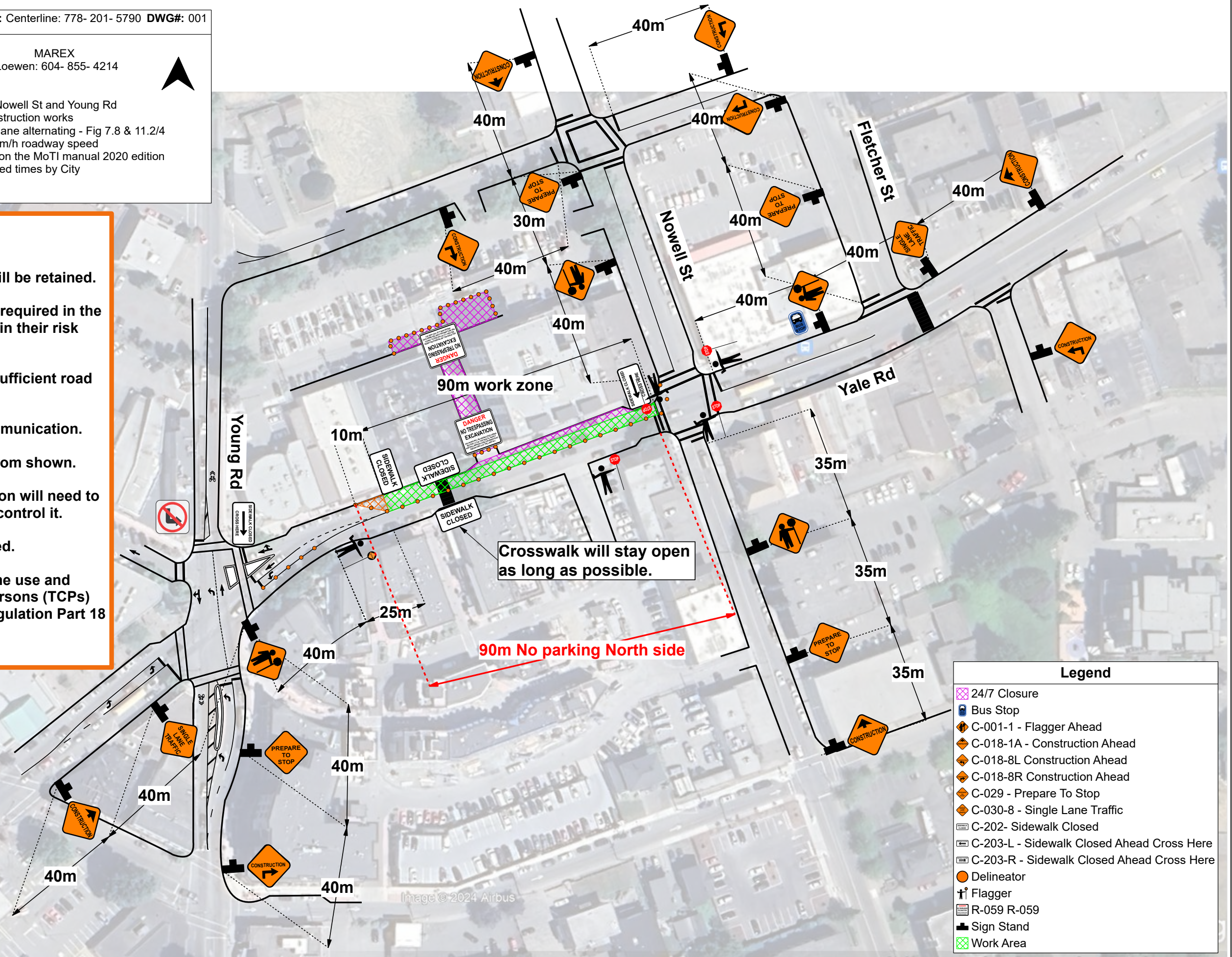

Legend	
	24/7 Closure
	Bus Stop
	C-001-1 - Flagger Ahead
	C-018-1A - Construction Ahead
	C-018-8L Construction Ahead
	C-018-8R Construction Ahead
	C-029 - Prepare To Stop
	C-030-8 - Single Lane Traffic
	C-202- Sidewalk Closed
	C-203-L - Sidewalk Closed Ahead Cross Here
	C-203-R - Sidewalk Closed Ahead Cross Here
	Delineator
	Flagger
	R-059 R-059
	Sign Stand
	Work Area